

10 PAINTER WOOD
BILLINGTON
BB7 9JD

£250,000



- Double-fronted stonebuilt cottage
- 2 double bedrooms & bathroom
- Spacious living room, dining room
- Fitted kitchen
- Rear garden adjoining fields
- Well presented accommodation
- Gas central heating
- 73 m2 (790 sq ft) approx.

honeywell.co.uk

Situated on a sought after road on the side of Whalley Nab, just outside the village of Whalley, this attractive double-fronted stonebuilt cottage offers well presented, charming accommodation comprising a living room with multi-fuel burner, separate dining room and fitted kitchen with doors onto the rear garden. On the first floor are two good-sized double bedrooms and a bathroom with a 3-piece suite and shower.

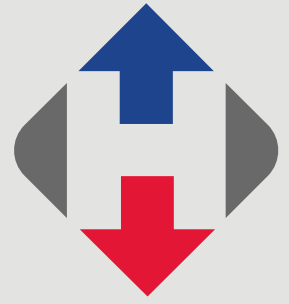

The property enjoys a good-sized tiered rear garden which adjoins open fields to the rear and enjoys a superb outlook over the surrounding area.

LOCATION: From the centre of Whalley drive in the direction of Billington, passing over the River Calder and then up the hill. Turn sharp left and up the hill opposite the nursery onto Painter Wood.

ACCOMMODATION: (Imperial dimensions in brackets: all sizes approximate):-

ENTRANCE: Through half-glazed front door into lounge.

LOUNGE: 4.3m x 4.6m (14'1" x 15'1"); with feature exposed stone chimney breast housing feature fireplace with Clearview cast iron multi-fuel stove set on flagged hearth, television point, staircase off to the first floor with understairs cloaks cupboard, pitch pine latch door leading to dining room.

DINING ROOM: 2.4m x 4.6m (8'0" x 15'1"); with windows to front and rear elevations, BT telephone point, pitch pine tongue and groove latch door leading to kitchen.

KITCHEN: 4.5m x 1.6m (14'11" x 5'2"); with attractive range of oak Shaker style wall and base units with complementary working surfaces and

splashback, one and a half bowl stainless steel Franke sink unit with mixer tap, integrated Bosch stainless steel double oven, Bosch stainless steel 4-ring gas hob with extractor over, plumbing for washing machine, space for fridge freezer, quarry tiled floor, door to the rear garden.

FIRST FLOOR:

LANDING:

BEDROOM ONE: 4.2m x 4.7m (13'8" x 15'6"); with window to front and rear elevations, feature cast iron working fireplace with stone surround and flagged hearth, overstairs storage cupboard housing Worcester central heating boiler and fitted range of built-in wardrobes.

BEDROOM TWO: 2.4m x 2.8m (7'10" x 9'2"); with loft access and BT telephone point.

BATHROOM: With 3-piece white suite comprising low suite w.c. with push button flush, pedestal wash handbasin with chrome mixer tap and panelled bath with chrome tap and Mira electric shower over, fully tiled walls, solid oak floor.





OUTSIDE: Forecourt garden with steps to the front door and planting areas.

To the rear there is an enclosed garden with three tiers and steps up to paved patio area, raised flower beds and steps up to second patio area with planting borders and flower beds. The third tier is a planting area. Timber boundary fence which adjoins open fields to the rear. The patio area offers excellent views across Whalley towards Pendle Hill and Kemple End.

HEATING: Gas fired hot water central heating system. Majority double glazed windows in UPVC frames.

SERVICES: Mains water, electricity, gas and drainage are connected.

TENURE: We are informed by the owners that the property is leasehold for the remainder of a 999 year lease. The ground rent is not collected. The garden is freehold.

COUNCIL TAX BAND D.

EPC: The energy efficiency rating for this property is D.



VIEWING: By appointment with our office.

SELLING YOUR OWN HOUSE? We will be happy to provide free valuation and marketing advice, without obligation - please ask for details.



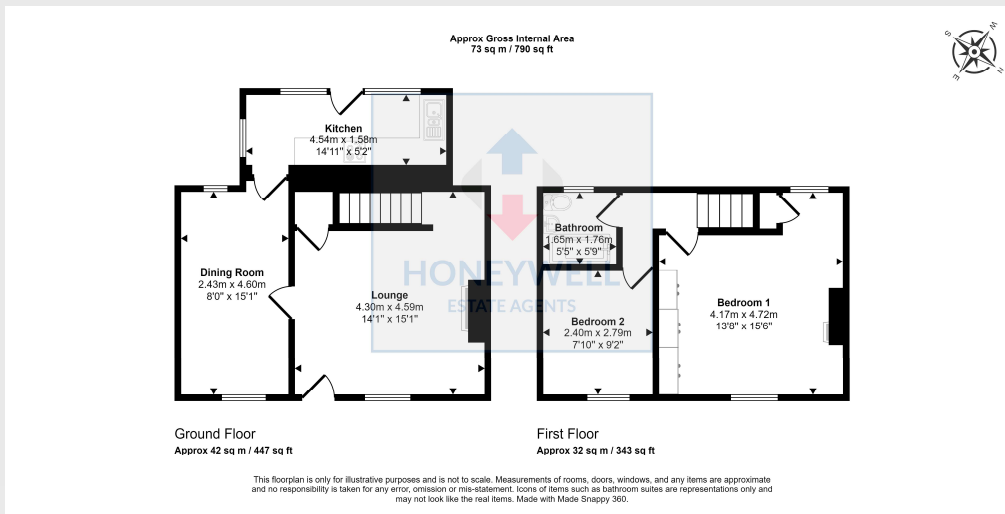

10 Painter Wood, Billington, BB7 9JD
MJ/CJ/120724

Selling your house? We will be happy to provide free valuation and marketing advice, without obligation - please ask for details

1 Castlegate, Clitheroe. BB7 1AZ
T: 01200 426041 E: houses@honeywell.co.uk

The Fountains, Barrowford. BB9 8LQ
T: 01282 698200 E: barrowford@honeywell.co.uk

HoneywellEstateAgents

HoneywellAgents

honeywell.co.uk

Please note: These particulars are produced in good faith, but are intended to be a general guide only and do not constitute any part of an offer or contract. No person in the employment of Honeywell Estate Agents Ltd has any authority to make any representation or warranty whatsoever in relation to the property. Photographs are reproduced for general information and do not imply that any item is included for sale with the property.